

Legend	
	40km/hr Timed School Zone
	Resident Access
	Tubular
	Work Area

- Notes:
1. Diagram not to scale
 2. Advance signage as per MUTCD Part 3 Cl 4.7.4
 3. Maximum length of work area is 1km
 4. Sign locations may be adjusted by -10% / +25% of the nominated distance should site conditions require this (ie visibility issue or driveway clash)
 5. Ensure all existing conflicting signs are covered.
 6. Ensure all workmen signs are removed while no workers are visible.

Application Term:	Long Term
Road Type:	Two way road
Traffic Volume:	Denmans Camp Rd (assumed volume): 9971vpd AADT (3.68% HV) based on Boat Harbour Drive data for segment between Denmans Camp Rd and Robert St
Travelled Path:	Past and Around
Control:	Nil
Operation:	Single lane closure with one direction detour
Working Hours:	7am - 6pm Monday to Saturday Detour to remain in place 24hr/day
Site Contacts:	Karen Edgerton - 0487 787 004 Peter Salisbury - 0439 379 890
Posted Speed:	Grevillea St: 50km/hr with school zone All other side streets: 50km/hr
Distance D:	Grevillea St: 15m All other side streets: 15m
Signage Setup:	1.5m min height. 2.1m minimum to underside where in a footpath
Site Comms:	2 way UHF Radio
Works Duration:	Estimate February 2023 to April 2023
Max Delay:	N/A
Min Lane Width:	3.0m (plus 0.5m clearance to all delineation devices)
Maximum Cone Spacing:	All areas within temporary 40km/h zone: 4m Merge Tapers: 9m Lateral Shift Tapers: 12m Other Areas: 18m

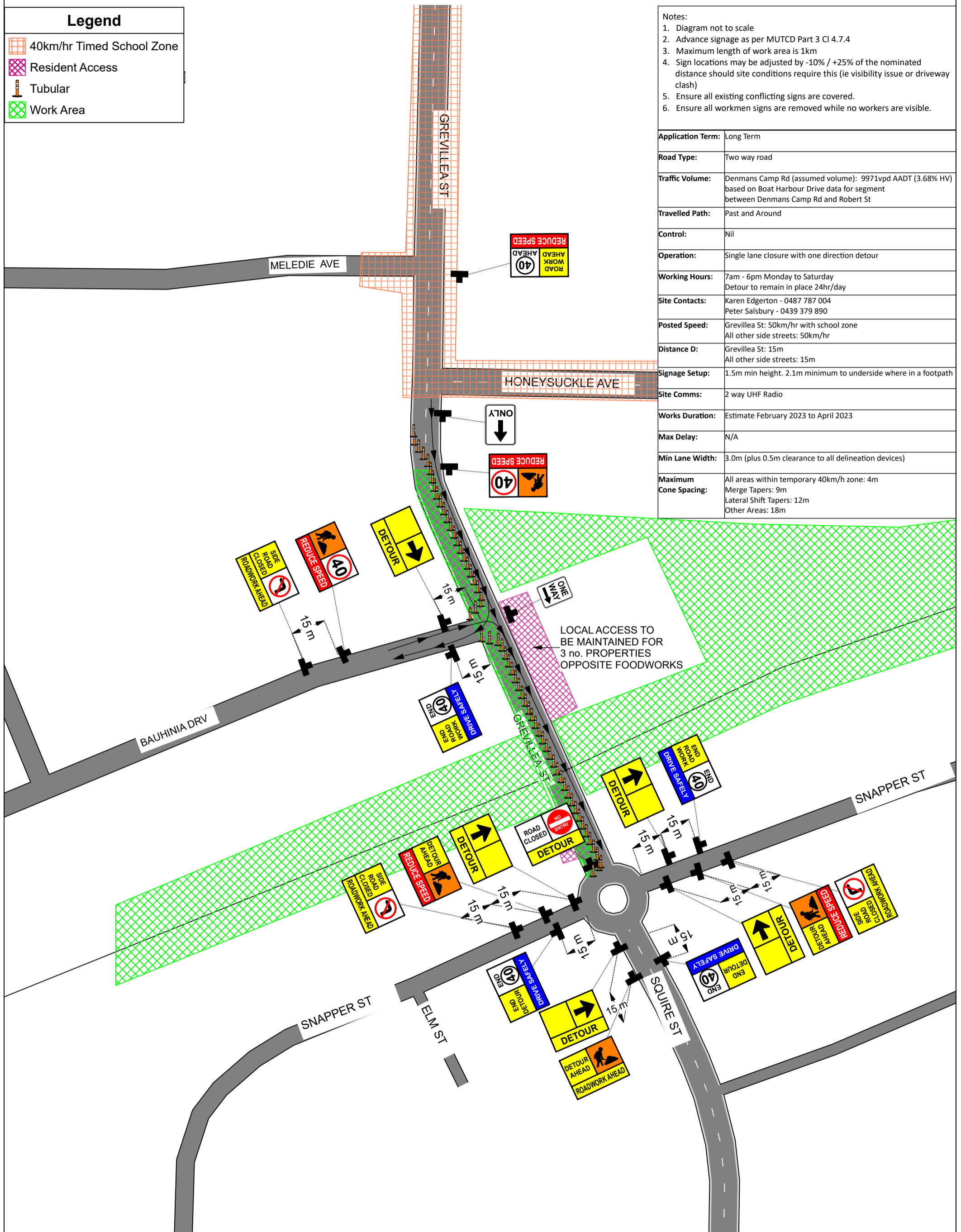

Date: 16-Dec-2022 Author: K Edgerton Project: Boundary Rd Extension - Denmans Camp Rd to Kawungan Way
TGS No.: 6177-012 West Rev: A TMD #: OP411
TMD Signature:

Comments:
This TGS has been drafted for RBCB, RCP and road construction works on western side of Grevillea St.
TGS drawn with reference to the MUTCD Part 3, November 2022 Edition.

N

 Sheet: 1 of 2

DETOUR MAP

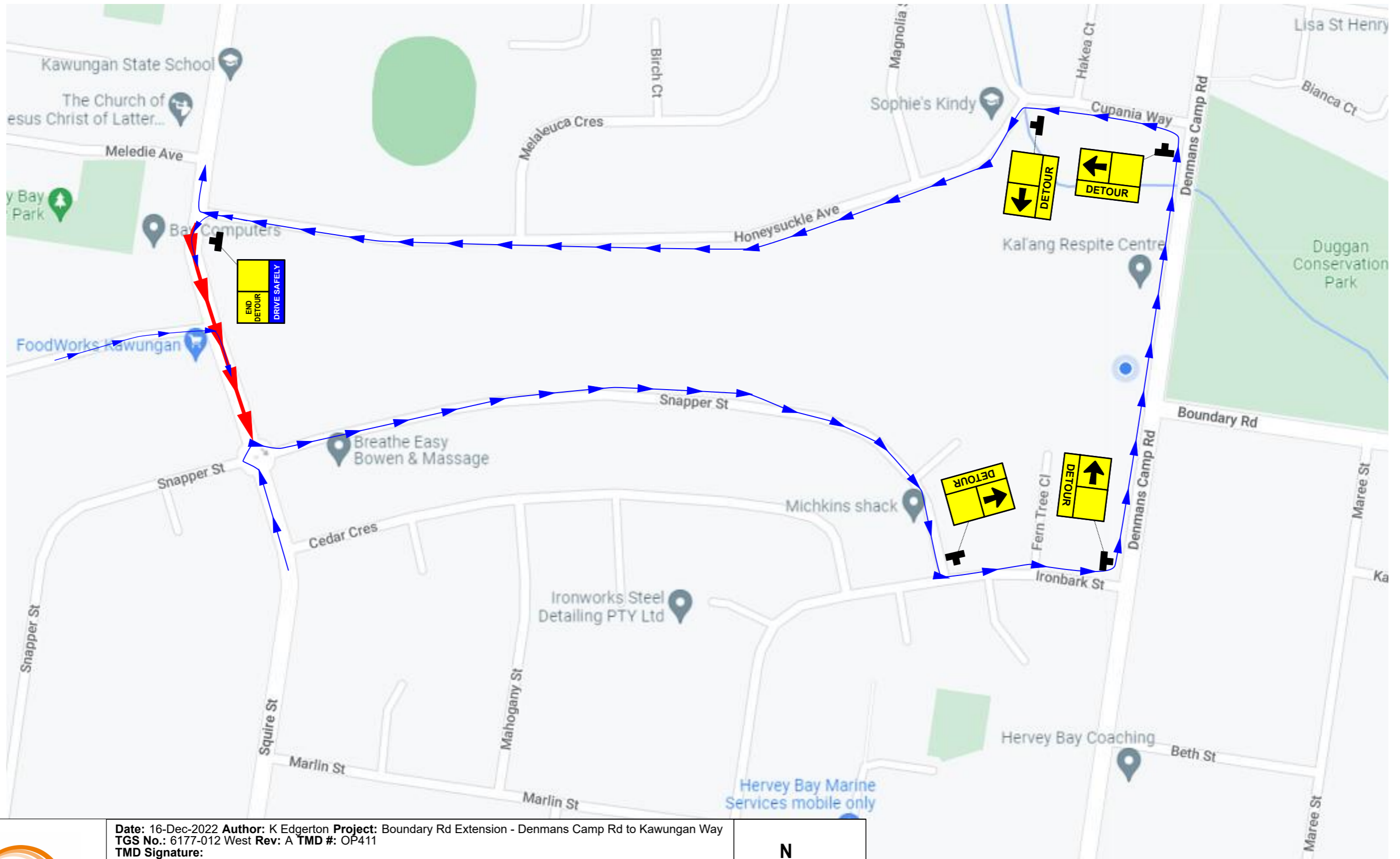

Date: 16-Dec-2022 **Author:** K Edgerton **Project:** Boundary Rd Extension - Denmans Camp Rd to Kawungan Way
TGS No.: 6177-012 West **Rev:** A **TMD #:** OP411
TMD Signature:

Comments:
 This TGS has been drafted for RCBC, RCP and road construction works on western side of Grevillea St.
 TGS drawn with reference to the MUTCD Part 3, November 2022 Edition.

