





**Legend**

-  40km/hr Timed School Zone
-  Resident Access
-  Tubular
-  Work Area

**Notes:**

1. Diagram not to scale
2. Advance signage as per MUTCD Part 3 Cl 4.7.4
3. Maximum length of work area is 1km
4. Sign locations may be adjusted by -10% / +25% of the nominated distance should site conditions require this (ie visibility issue or driveway clash)
5. Ensure all existing conflicting signs are covered.
6. Ensure all workmen signs are removed while no workers are visible.

<b>Application Term:</b>	Long Term
<b>Road Type:</b>	Two way road
<b>Traffic Volume:</b>	Denmans Camp Rd (assumed volume): 9971vpd AADT (3.68% HV) based on Boat Harbour Drive data for segment between Denmans Camp Rd and Robert St
<b>Travelled Path:</b>	Past and Around
<b>Control:</b>	Nil
<b>Operation:</b>	Lane closure with one direction detour
<b>Working Hours:</b>	7am - 6pm Monday to Saturday detour to remain in place 24hr/day
<b>Site Contacts:</b>	Karen Edgerton - 0487 787 004 Peter Salisbury - 0439 379 890
<b>Posted Speed:</b>	Grevillea St: 50km/hr with school zone All other side streets: 50km/hr
<b>Distance D:</b>	Grevillea St: 15m All other side streets: 15m
<b>Signage Setup:</b>	1.5m min height. 2.1m minimum to underside where in a footpath
<b>Site Comms:</b>	2 way UHF Radio
<b>Works Duration:</b>	Estimate January 2023 to February 2023
<b>Max Delay:</b>	N/A
<b>Min Lane Width:</b>	3.0m (plus 0.5m clearance to all delineation devices)
<b>Maximum Cone Spacing:</b>	All areas within temporary 40km/h zone: 4m Merge Tapers: 9m Lateral Shift Tapers: 12m Other Areas: 18m

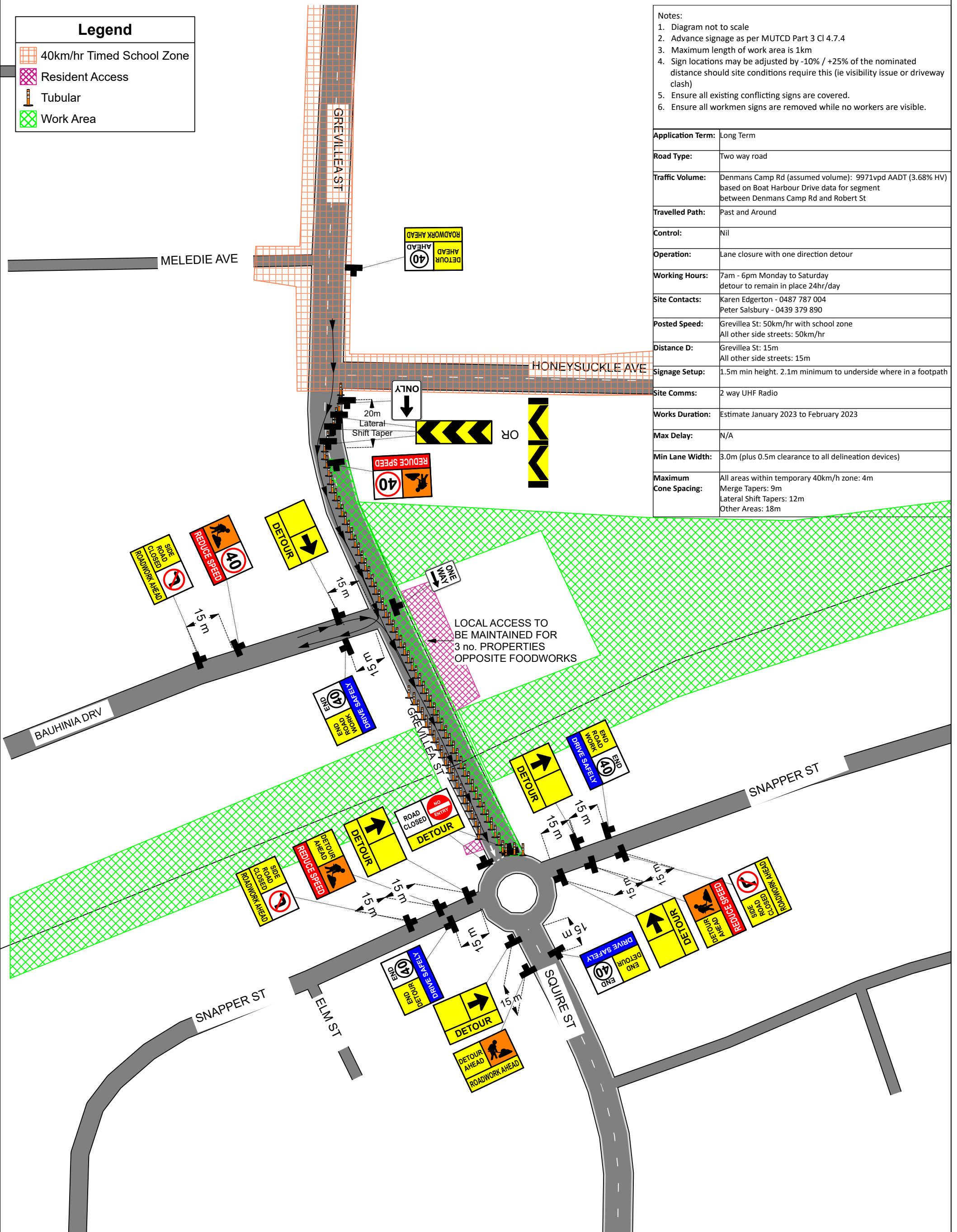

LOCAL ACCESS TO BE MAINTAINED FOR 3 no. PROPERTIES OPPOSITE FOODWORKS



**Date:** 16-Dec-2022 **Author:** K Edgerton **Project:** Boundary Rd Extension - Denmans Camp Rd to Kawungan Way  
**TGS No.:** 6177-012 East **Rev:** B **TMD #:** OP411  
**TMD Signature:**

**Comments:**  
 This TGS has been drafted for RCBC, RCP and road construction works on eastern side of Grevillea St.  
 TGS drawn with reference to the MUTCD Part 3, November 2022 Edition.

N  
  
 Sheet: 1 of 2

# DETOUR MAP

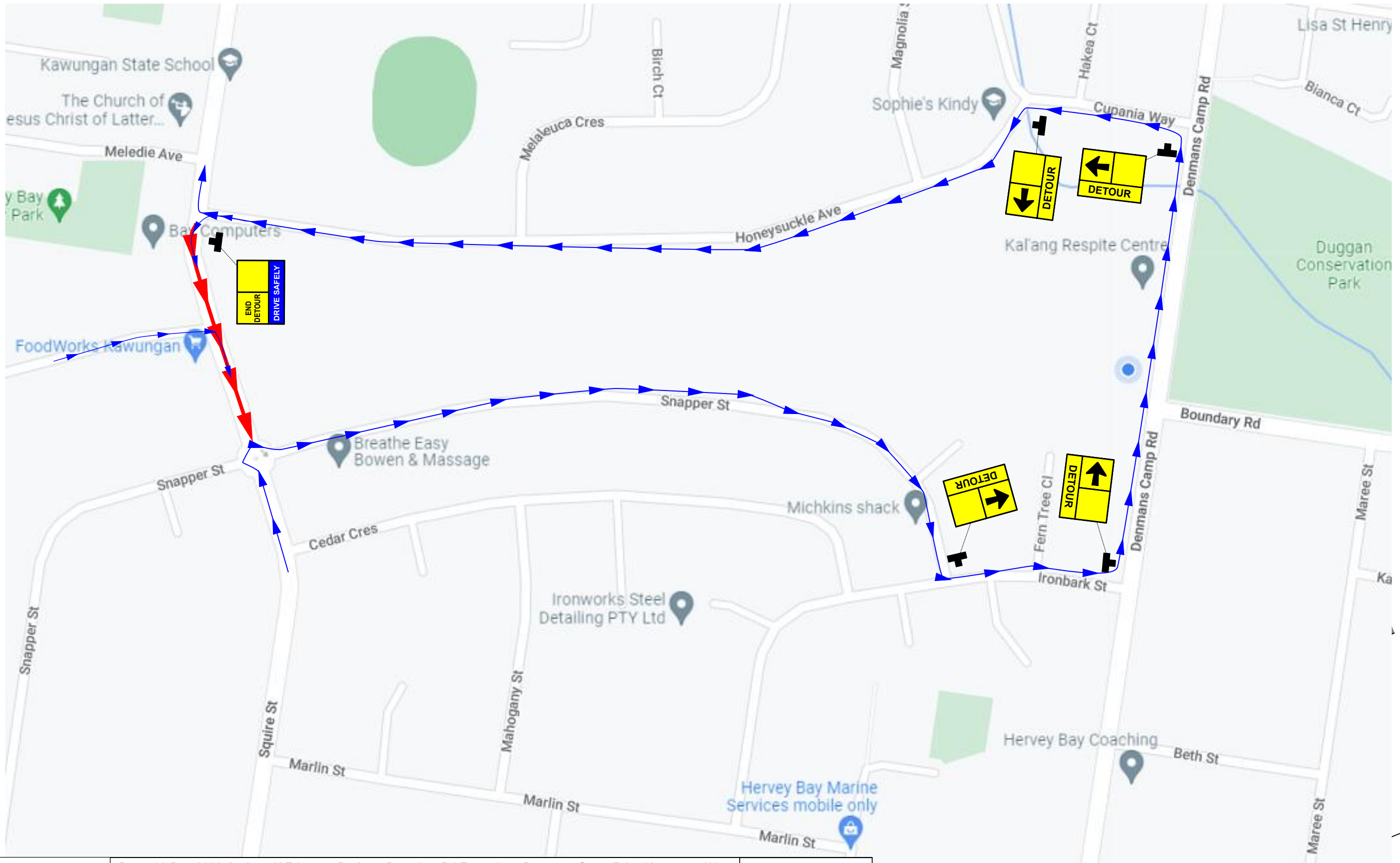

**Date:** 16-Dec-2022 **Author:** K Edgerton **Project:** Boundary Rd Extension - Denmans Camp Rd to Kawungan Way  
**TGS No.:** 6177-012 East **Rev:** B **TMD #:** OP411  
**TMD Signature:**

**Comments:**  
 This TGS has been drafted for RCBC, RCP and road construction works on eastern side of Grevillea St.  
 TGS drawn with reference to the MUTCD Part 3, November 2022 Edition.

